

BPW ECO plus system

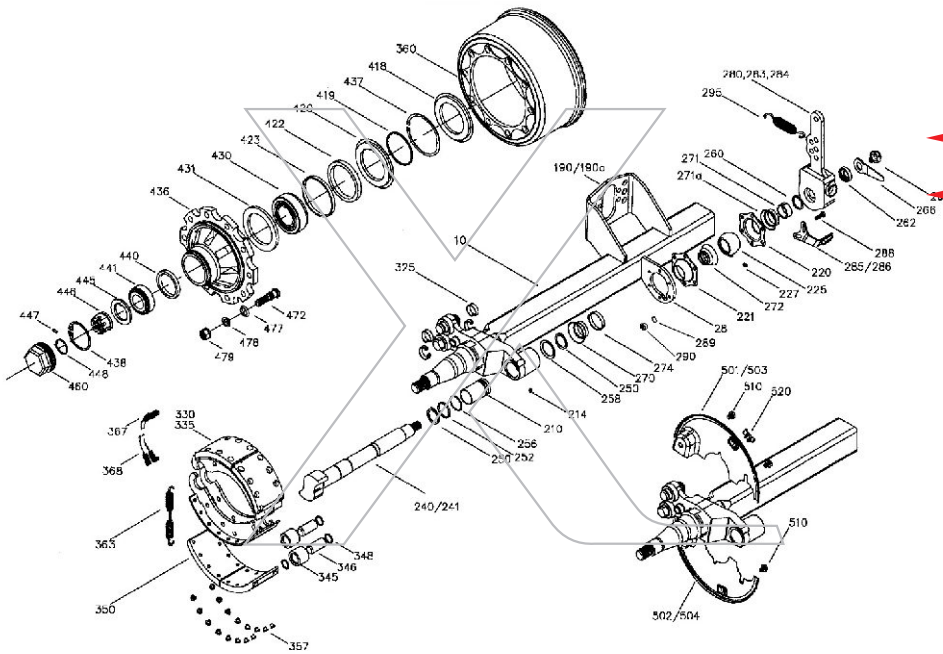

10. Axle Beam	271. Bush	431. Grease Shield
28. Plate	271a Seal	432. Seal
190. Booster Bracket	272. Seal	436. Hub
210. Bush	274. Seal	437. Locking Ring
214. Grease Nipple Camshaft Holder	280. Slack Adjuster	438. Ret. Ring
220. Bearing Box	285. Distance Plate	440. Thrust Washer
221. Bearing Box - for G/ Nipple Bush Ass'y	295. Return Spring	441. Roller Bearing - Outer
225. Bush	325. Locking Ring	445. Washer
227. Grease Nipple	330. Brake Shoe Compl.	446. Axle Nut
227a Cover	335. Brake shoe w/o lining	447. Wedge Bolt
240. Camshaft LH	345. Roller	448. Locking Ring
241. Camshaft RH	346. Bolt	460. Hub Cap
250. Circlip	348. Ring	472. Wheel Stud
252. Ring	350. Brake Lining	477. Ring
256. O-Ring	357. Rivet	478. Spring Washer
258. Seal	363. Return Spring	479. Wheel Nut
262. Washer	367. Positioning spring - str.	501. Dust Cover
266. Wear Indicator	368. Positioning spring - Hooked	502. Dust Cover
268. Hex Nut	380. Brake Drum	503. Dust Cover
270. Seal	422. Oil Seal	504. Dust Cover
	423. Ring	510. Lock Screw
	428. Seal	520. Plug
	430. Roller Bearing - Inner	