

## U22500 series trailer axle

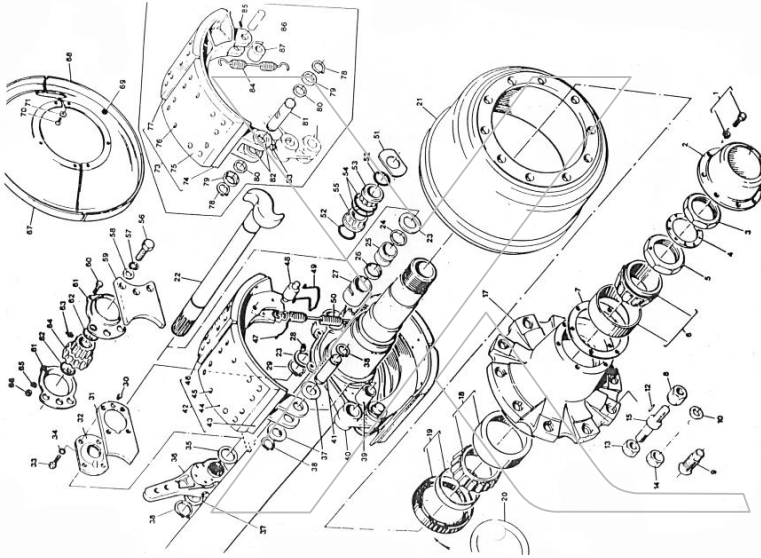

**BRAKE ASSEMBLIES**



- |                                     |                                   |                               |
|-------------------------------------|-----------------------------------|-------------------------------|
| 1. Bolt Hub Cap                     | 10 stud 11.1/4ml                  | 56. Screw                     |
| 2. Hub Cap Grease Oil               | 22. Camshaft                      | 57. Washer Spring             |
| 3. Nut Lock                         | RH 420 brake LH 420 brake         | 58. Washer                    |
| 4. Washer Lock                      | 23. Washer                        | 59. Bracket Cam               |
| 5. Nut Bearing Adjust               | 24. O-Ring                        | 60. Screw                     |
| 6. Bearing Cup & Cone Outer         | 25. Bush                          | 61. Housing Spherical Bearing |
| 7. Gasket Grease Oil                | 26. Seal                          | 62. O-Ring                    |
| 8. Nut Wheel                        | 27. Bush                          | 63. Nipple Grease             |
| RH 7/8" BSF                         | 28. Nipple Grease                 | 64. Bearing Spherical         |
| LH 7/8" BSF                         | 29. Circlip                       | 65. Washer Springs            |
| 9. Sleeve RH 3/4 x 1.1/8" Budd      | 30. Nipple Grease                 | 66. Nut                       |
| LH 3/4 x 1.1/8" Budd                | 31. Bracket Cam Bearing 420 brake | 67. Dust Cover Set.           |
| 10. Cone Wheel Metric Outer         | 32. Bearing Spherical             | (Both)                        |
| 11. Not required anymore            | 33. Capscrew Spherical Bearing    | 68. Dust Cover Half Only      |
| 12. Dowel                           | 34. Washer                        | 69. Plug Rubber               |
| 13. Nut Lock 7/8" BSF               | 35. Washer                        | 70. Screw                     |
| 14. Spacer Stud (Unbraked Axle)     | 36. Slack Adjuster                | 71. Washer                    |
| 15. Stud Wheel RH 7/8" BSF 2/Wheel  | 37. Washer                        | 72. Not required anymore      |
| LH 7/8 BSF 2/Wheel                  | 38. Circlip                       | 73. Shoe & Lining             |
| RH 7/8" BSF 1/Wheel                 | 39. Bush                          | Assy HD                       |
| LH 7/8" BSF 1/Wheel                 | 40. Spider Brake 420 Brake        | 74. Shoe Unlined HD           |
| 22mm x 1.5                          | 41. Pin Anchor                    | 75. Lining Anchor End         |
| RH 3/4" Budd                        | 42. Shoe & Lining Assy 420x180    | 76. Rivets                    |
| LH 3/4" Budd                        | 43. Shoe Unlined 420x180          | 77. Lining Cam End            |
| 16. Not required anymore            | 44. Lining Anchor End             | 78. Circlip                   |
| 17. Hub 10 Stud 335mm PCD           | 45. Rivet                         | 79. Retainer                  |
| 8 Stud 275mm PCD                    | 46. Lining Cam End                | 80. Felt-Anchor Pin           |
| 8 Stud 285mm PCD                    | 47. Pin                           | 81. Pin Anchor                |
| 10 Stud 11.1/4" PCD                 | 48. Roller                        | 82. Bush Anchor Pin           |
| 18. Bearing                         | 49. Spring Retaining              | 83. Lock Anchor Pin           |
| 19. Seal Oil/Wear Sleeve            | 50. Spring Release                | 84. Spring Release            |
| Grease Oil                          | 51. Washer                        | 85. Screw Lock                |
| 20. Cover Oil Seal (Unbraked Axles) | 52. O-Ring                        | 86. Pin Roller                |
| 21. Drum Brake 420x180              | 53. Bush Inner                    | 87. Roller                    |
| 10 stud 335ml                       | 54. O-Ring                        |                               |
| 8 stud 275ml 8 stud 285ml           | 55. Bush Outer                    |                               |

